

Zonex GATEWAY

BACnet IP gateway for the GEN X system

Overview

The GATEWAY is a BTL certified, high performance, configurable, cost effective way to easily integrate the GEN X zoning system into building management systems via BACnet IP.

System integrators world-wide have benefited from the value of and ease of interoperability that gateways provide. Now, Zonex's GATEWAY for the GEN X adds that same value by running a robust FieldServer protocol conversion software on a highly cost effective platform. The GATEWAY is backed by the experience, engineering expertise and proven technical support that integrators have come to expect.

The GATEWAY includes browser-based tools to make it easy to set-up and perform diagnostics including determination of status, network settings, node information, map descriptors and more.



QuickServer Features and Benefits

- Interface 250 device points.
- DIN rail mount standard.
- BACnet IP COV support for fast data communication while reducing the traffic over a BACnet IP* network.
- On-board diagnostics allow easy troubleshooting for Ethernet communications.
- Seamlessly integrates the GEN X zoning system with a BMS.

* No option for BACnet MS/TP

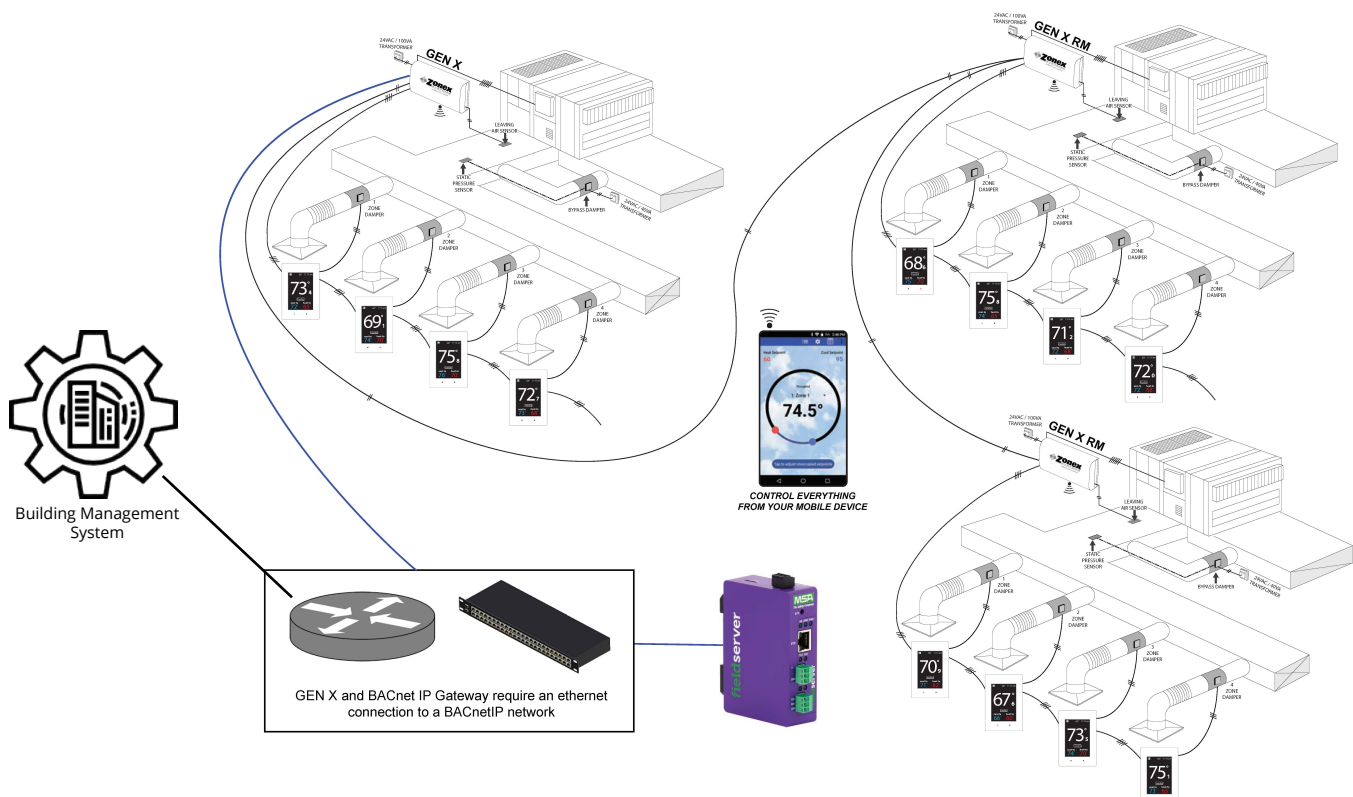

FieldServer Offers

- BTL certified.
- Over 20 years of experience in design and manufacture of building automation gateways with thousands of installations.
- Best effort e-mail support from **Chipkin**.
- **4 hours of phone support and unlimited email support from Chipkin can be purchased through Zonex Systems at an additional cost.**

Accessories

- Accessory Kit includes AC power supply, Ethernet cable, mini-screwdriver and a USB flash drive with all data sheets, manuals, notes, the discovery tool and more.

Hardware Specifications

Communication

Ethernet: 10/100BaseT, MDIX, DHCP

* No option for BACnet MS/TP

Environment

Operating Temperature: -20 to 70°C (-4 to 158°F)

Relative Humidity: 10-95% RH non-condensing

Other

Web configuration

On-board diagnostics

DIN rail mount included

Construction

HxWxD: 4 x 1.1 x 2.7 in (10.16 x 2.8 x 6.8cm)

Weight: 0.4 lbs (0.2 Kg)

Power Requirements *

Input: 24VAC 0.125A; 9-30VDC 0.25A @12 VDC

Max Power: 3W

*Supports both Full-Wave and Half-Wave AC

Approvals

CE and FCC Part 15 B & C

BTL marked and KC certification

UL 60950-1 and CAN/CSA C22.2

DNP 3.0 and Modbus conformance tested

RoHS3, UKCA, and WEEE compliant

ODVA conformant

